

# TGP53 WIFI THERMOSTAT USER GUIDE



THIS THERMOSTAT IS SUITABLE FOR WATER HEATING, ELECTRIC HEATING AND GAS BOILER

## Welcome

Thank you for your trust and support. By adopting higher-end technology and more perfect technology, your new thermostat will provide you with the right temperature environment every day in the future, making your life more comfortable and your living environment more stylish and beautiful. For detailed instructions on the installation and use of this thermostat, please read this manual carefully. Please contact a professional to install the thermostat for you and install and use the product to the extent permitted by law.

## Application

Intelligent digital temperature controller is a floor heating system suitable for room temperature control and household temperature control. It controls the operating state of the floor heating equipment by comparing the ambient temperature with the set temperature, which improves comfort and achieves energy saving. This digital temperature controller adopts microcomputer control technology and is equipped with full-screen display touch buttons, which is elegant in design and easy to use. The thermostat has manual automatic, programmable and state memory functions.

## Product packaging

Thermostat host	1 PC	Qualification certificate	1 PC
Sensing line (optional)	1 PC	Manual	1 PC
Screw	2 PCS		

## Product Model

- WP Plumbing 3A
- EP Electric Heating 16A
- WPB linkage, gas boiler 3A

## Technical Data

1. Temperature Sensor :NTC
2. Temperature accuracy :  $\pm 1^{\circ} \text{C}$
3. Power consumption: < 1W
4. Voltage: AC100-240V 60HZ
5. Load current: water heater 3A / electric heater 16A
6. Temperatures Setting :5-60° C

## User Notes

1. Please read this manual carefully. Improper operation may damage the product or cause dangerous conditions.
2. The installation personnel must be well-trained and experienced service technicians.
3. After installation, please read this manual carefully and operate the product according to the instructions.

Caution: Risk of electric shock or equipment damage.

## Wiring Diagram

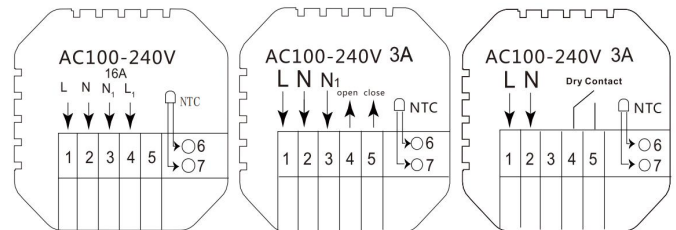

Note: WP for water heating; EP for electric heating; WPB for gas boiler

## Installation procedure

This product is installed with a standard 86 control switch (in compliance with European regulations).

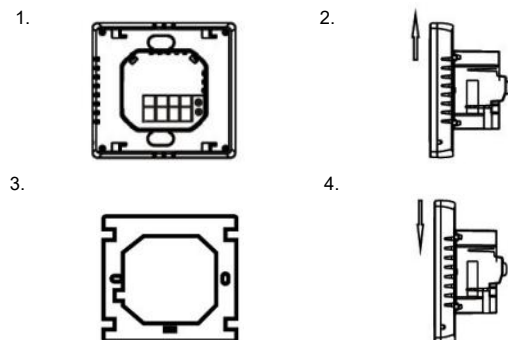



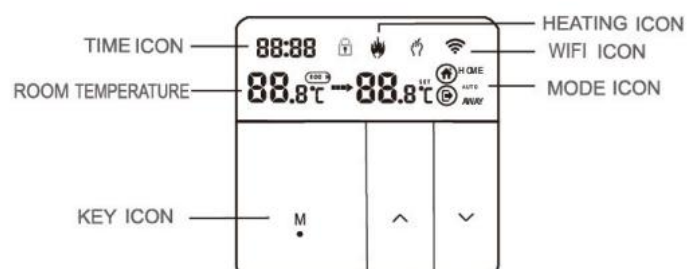

1. Connect the power box according to the wiring diagram.
2. Push the panel up and take down the panel.
3. Install the fixed plate of thermostat in electrical connection box with screws.
4. Make the panel buckle to the fixed plate and push it down.

## Description of display & Icon



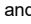

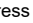
## Operating Instruction

1. Power on/off: Long press **M** key for 5 seconds to turn on/off the thermostat.
2. Short press the **M** key to switch between manual and Away modes.
3. Long press M key and  key to enter the clock setting, press M key to switch Settings Item, press  and  keys to adjust the value of each parameter. Note: the time of WIFI model will be Automatically gets Internet time.
4. Press  and  for 5 seconds to add or cancel the child lock.
5. WIFI link: When the thermostat is on, long press  button for 5 seconds and the thermostat display will come out. Now the WIFI icon flashes, at this time the thermostat into the state of code.

## Advanced options

When POWER OFF, press the M key and the  key for 5 seconds to enter the advanced option setting.

Press M to enter the next option, press  and  to adjust, and long press M to exit the height Level option.

1	Temperature compensation	The default value of the calibration room temperature is -1 °C. Press the up and down keys to adjust. The adjustable range is 9.9 °C to -9.9 °C.
2	Sensor selection	The temperature sensor is selected as IN by default. Press the up and down keys to adjust as IN respectively, indicating that the internal.
3	Modify the temperature limit	The default temperature limit value is 60 °C. Press the up and down keys to adjust the range from 25 °C to 95 °C.
4	Temperature difference start	The default temperature difference is set to 1 °C. Press the up and down keys to adjust the range to 0.5-10 degrees.
5	Antifreeze function	Set the default anti-freeze function to OFF, display OFF, press the up key to turn on anti-freeze and display ON.
6	Holiday option and turn off weekly programming	5: Two-day weekend 6:Single day off 7: No rest OFF: Turn off programming.
7	Primary and secondary reverse selection	Set the default main and auxiliary reversal to 00. Press the up and down keys to adjust 00 main reversal. 01 indicates auxiliary reversal.
8	Backlight brightness	00 : Turn off the backlight 01 : Micro-light 02 : Medium brightness 03 : high brightness
9	Set upper temperature limit	The default value of the set temperature upper limit is 60°C, and the adjustment range is 15-95 °C by pressing the up and down keys.
10	Restore Factory Defaults	Set to restore the factory default setting to display "--", Press the up button to adjust the display "----", long press the <b>M</b> button to restore the factory settings.

## About WIFI connection

Before using the WIFI thermostat for the first time, you should set the WIFI signal and configuration through your smart phone or tablet to allow communication between your connected devices.

WIFI link: Bluetooth thermostat, please turn on the phone's Bluetooth

**WIFI connection:** When the thermostat is on, long press  key for 5 seconds, the WIFI icon flashes on the thermostat display, and the thermostat enters the code matching state.

1. Download the APP

Search for "Tuya" in App market or scan below QR Code to download



2. Register Account

If you don't have an APP account yet, you can choose to register or log in via SMS verification code. Click "Create a new account", you will enter the Tuya Smart Platform Privacy Policy page. After you click Agree, you will officially enter the mobile phone registration page.

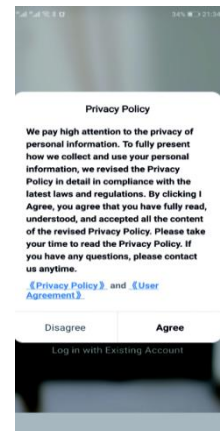

The system automatically determines the current country/region. You can also select the country/region manually. After entering your mobile phone number or email address, click "get verification code". Enter the received verification code, then enter the password, and click "finish" to register successfully.

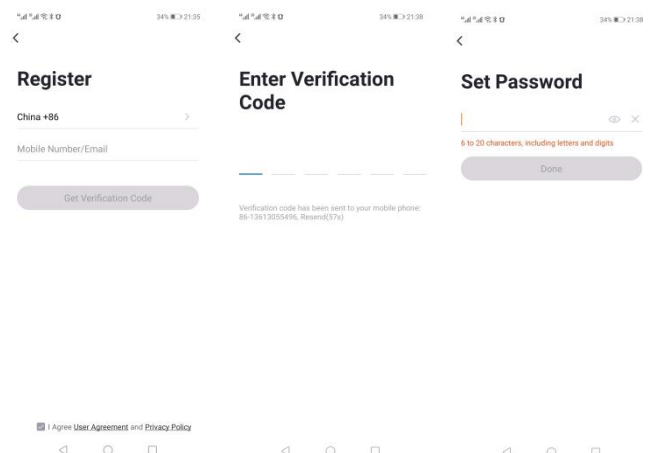

### 3. Add device

Click "add device" or "+" on the top right of the APP homepage to enter the "add device" page. Currently, there are two ways to manually add device and search device.

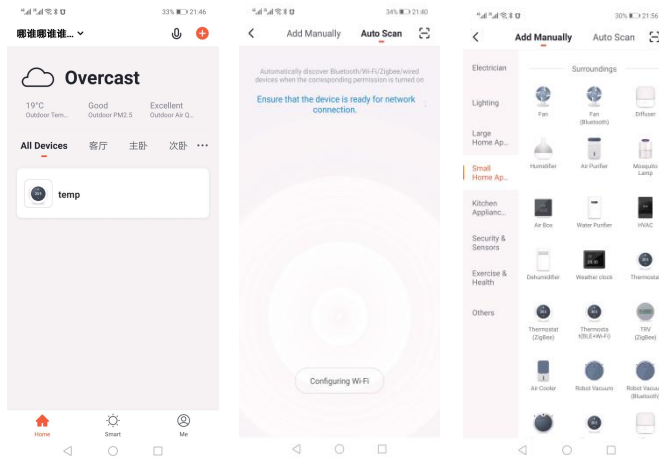

Find the thermostat product ( WIFI model ) in the device list. In the specified network mode, the indicator flashes ( slowly flashes ) and then click the confirm button on the page. Select the device's work area to the WIFI of the Internet and enter the WIFI password. Click "OK" to enter the matching network process.

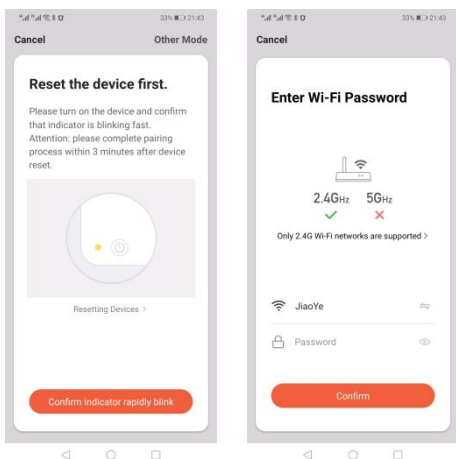

If the default mode distribution network is selected, the distribution process APP is show in figure 1 below, and the distribution network successfully displays the interface shown in figure 2. The name of the device can be changed, and the location of the room can be selected.

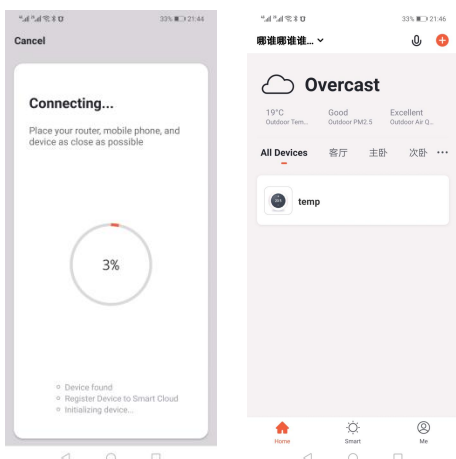

If the distribution network fails, the APP will display the page shown in the figure below. You can choose to add or view the help again. Note: if the connection fails, please confirm whether the temperature control device has entered the code matching state, refer to item 6 of the operation manual.

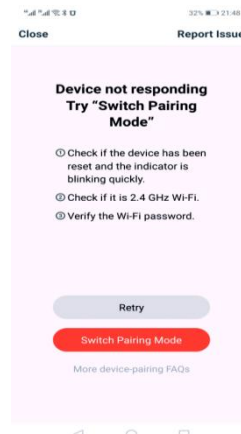

### 4. Display of temperature controller APP interface

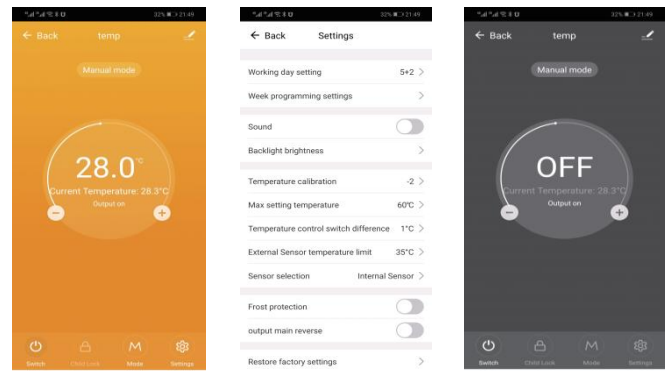

Additional information or notes related to the device setup and interface display.